



**PRODUCT WEAPON CATEGORY DIFFICULTY LEVEL PUBLISHED TOOLS REQUIRED**

**PRS FAL Installation Medium 03.06.07 FN-FAL Stock Removal Tool, Flat-Head Screw Driver, 1/8" Hex Key, Rubber Mallet**



## Installation of the PRS2 Stock for the FAL

The PRS2 is a multi-weapon platform, precision adjustable stock. The PRS2-FAL version is designed to replace the fixed butt stock on the FN-FAL metric pattern rifle. All mounting hardware is included. Only a qualified armorer or gunsmith should perform installation of this equipment. If you do not meet these requirements, have a qualified professional perform this installation. *NOTICE: Magpul Industries shall not be responsible for injury, death or damage to property resulting from improper installation, misuse or illegal use of this product.*



**WARNING: Observe safe firearm handling practices at all times. Failure to do so may result in grievous bodily injury or death.**

### PARTS INCLUDED (NOT TO SCALE):



1. 1-1/8" Button Head Cap Screw (2)



2. Cover Plate



3. Quick Release Plate

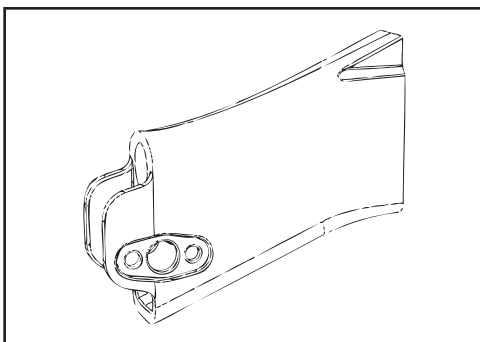

### STEP 1 - Confirm Required Stock Type

**WARNING:** Before beginning installation, make sure the weapon is unloaded and the safety engaged. First, confirm the FAL-type Interface has been included. If the interface differs from that pictured, contact Magpul for a replacement stock at 1.877.4MAGPUL.

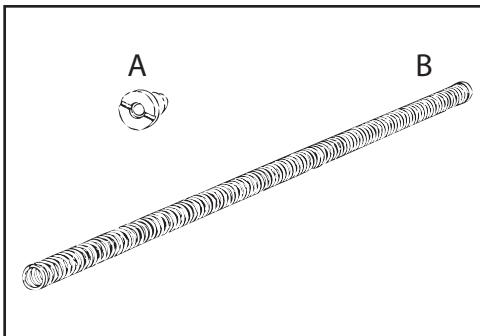

### STEP 2 - Remove Original Stock

The PRS2 utilizes several pieces from the OEM stock. Remove original stock per armory guidelines. Confirm that the following parts are present:

- A. Spring Plug (1)
- B. Return Spring Assembly (1)

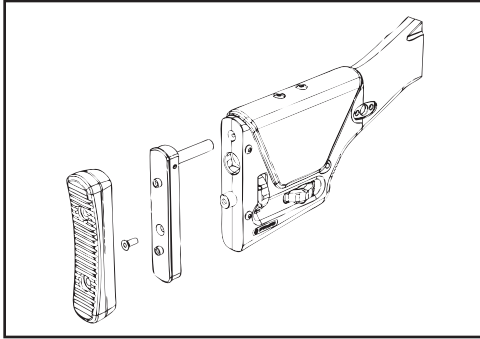

## STEP 3 - Remove Buttplate

Remove Buttpad. Using a 1/8" Hex Key, unscrew Buttplate Mounting Screw (1/2" Flat-Head Screw) and set aside. Remove Buttplate Assembly.

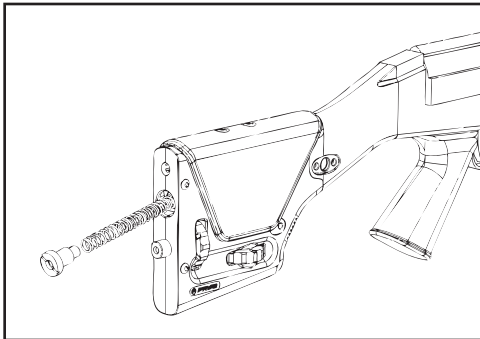

## STEP 4 - Mount Stock

Slide PRS-FAL stock over receiver extension. Using FN-FAL Stock Removal Tool, reinstall Return Spring and Spring Plug and tighten to armory specifications.

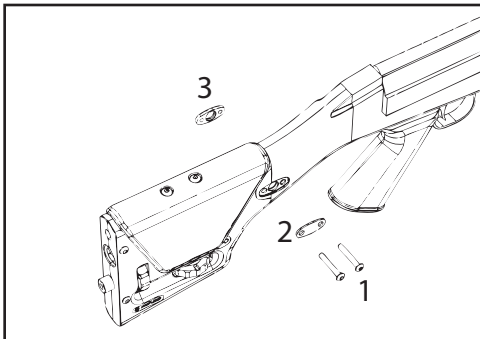

## STEP 5 - Install Quick Release Sling Mount (Reversible)

Mount *Cover Plate* in right-side slot on FAL Interface, and feed 1-1/8" *Button Head Cap Screws* through holes. Mount *Quick Release Plate* in left-side slot, making sure side with smaller diameter hole is facing out. Tighten screws using 1/8" Hex Key. Parts may be reversed for left-handed users.

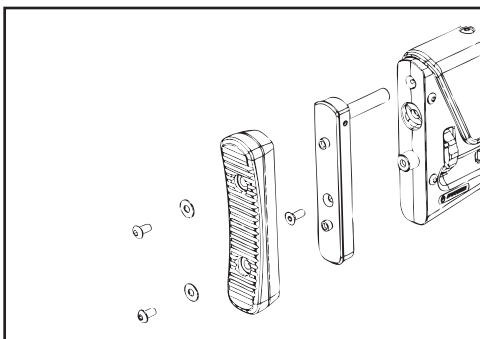

## STEP 6 - Install Buttplate and Recoil Pad

Using adjustment knob, extend *Buttplate Shaft* to maximum length. Using 1/8" Hex Key, reinstall *Buttplate* using 1/2" Flat-Head Screw. Fit *Rubber Buttpad* to *Buttplate* making sure it is fully seated. Note: Top end of *Rubber Buttpad* is round, bottom end is flat. Reinstall screws with washers and hand tighten.

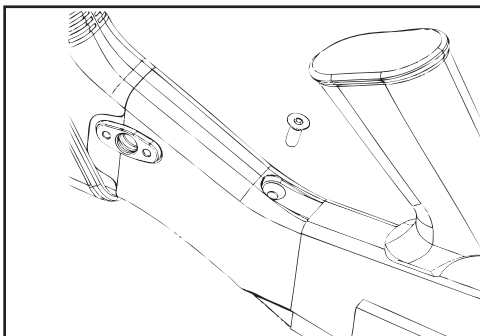

## STEP 7 - Install Tang Screws (Optional)

The OEM Lower Tang Screw is not required but may be reused with the PRS2. Using a 1/8" drill bit, drill a hole into the bottom of the FAL Interface using the FAL Lower Receiver hole as a guide. Reinstall screw. Note: The screw will form its own threads during first installation and will require additional force.